

RECOMMENDED P.C.B. HOLE LAYOUT  
 COMPONENT SIDE VIEW(TOLERANCE: +/-0.05)

REV.	DESCRIPTION	APPD	DATE
A/3	增加C. 50倒角防呆	PENTIUM	0121'10
A/4	改变端子外壳力臂	PENTIUM	0407'10

NOTES:

1. MATERIAL:  
 HOUSING: HIGH TEMPERATURE THERMOPLASTIC  
 UL94V\_0,COLOR:BLACK.  
 CONTACT: COPPER ALLOYS.  
 COVER: COPPER ALLOYS OR STEEL.
2. PLATING:  
 UNDERPLATE: NICKEL.  
 CONTACT AREA: GOLD OVER NICKEL.  
 SOLDER AREA: TIN OVER NICKEL.
3. MULTIMEDIA CARD COMPATIBLE

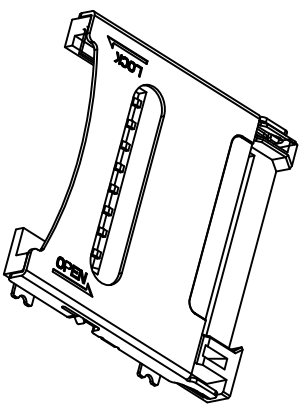

PART NO: TFX2-ES51-1111		MATERIAL:	
LOT NO: 1011001000	FINSH:		
UNIT: MM	SIZE:	TITLE: T-FLASHII掀盖模定式 - 1. 8H型	
TOLERANCES: GENERAL		DR: PENTIUM 0117'00	DWG NO: FP-090006
X.X=±0.35	ANGLE: X.X=±3.0°	CHK:	REV: A/4
X.XX=±0.25	X.XX=±2.0°	APP:	SCALE: SHEET: 1 OF 2
X.XXX=±0.15			

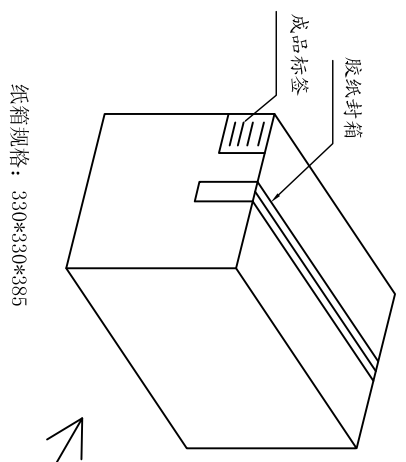
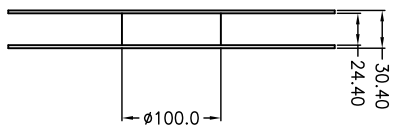
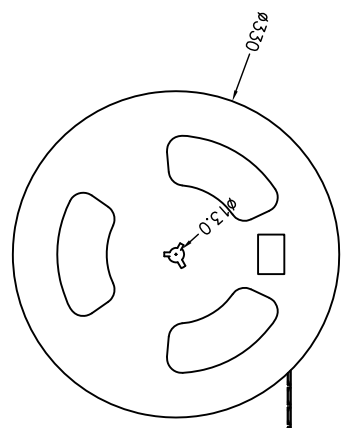
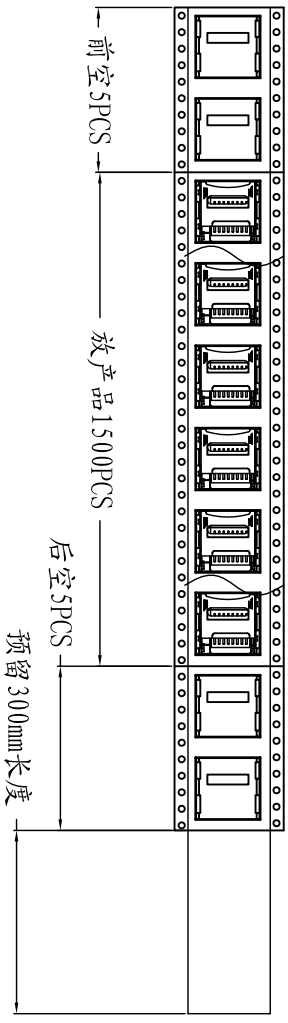
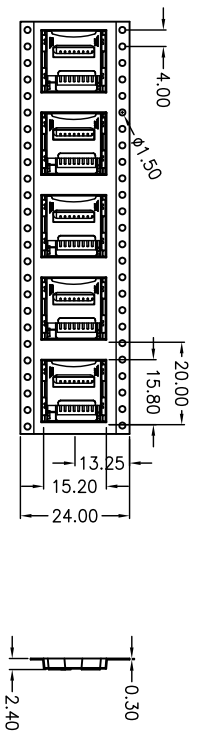

NO. 4

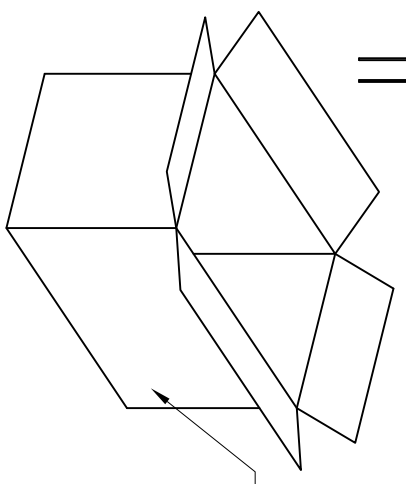
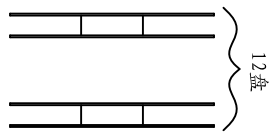

NO. 3

1. 材质要求:
- 1.1 纸箱的材质要求为B=B; 外形尺寸为33\*33\*38, 50M;
  - 1.2 卷盘的材料为PVC; 卷盘的外形尺寸为 $\phi 330 \times 30.4$ ;
  - 1.3 卷带的材料为PVC; 卷带的外形尺寸为302.00\*2.4\*2.7mm
2. 包装要求:
- 2.1 将卷带放入包装机后, 前空5PCS, 后放产品1500PCS, 再后空5PCS, 上带留300MM长度。
  - 2.2 将包装好的产品从包装机上取下并包装好;
  - 2.3 把累叠好的12盘叠放入纸箱中央并180set;
  - 2.4 把包装好的成品打包封箱, 并在纸箱外贴上标签

REV.	DESCRIPTION	APPD	DATE

PART NO: TFX2-EB51-1111		MATERIAL:	
LOT NO: 1011001000	FINSH:		
UNIT: MM	SIZE:		
TOLERANCES: GENERAL		TITLE: T-FLASHII掀盖模定式 - 1. 8H型	
X.X $\pm$ 0.35	ANGLE:	CHK: DR: PENTUM 0117.00	DWG NO: FP-090005
X.XX $\pm$ 0.25	X.X $\pm$ 3.0'	APP:	SCALE:
X.XXX $\pm$ 0.15	X.XX $\pm$ 2.0'	REV: A/4	
		SHEET: 2 OF 2	