

# 9001 Series

## DIN41612 Half Q Type Female

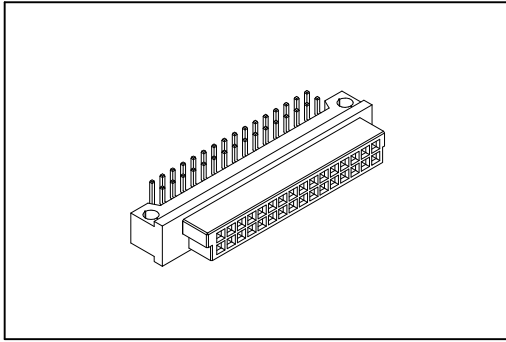

### Material:

Housing: Thermoplastic Polyester Glass Filled UL94V-0.  
 Contacts: Copper Alloy.

### Electrical Characteristics:

Current Rating: 2 A.  
 Dielectric Withstanding Voltage: AC 1000V.  
 Insulator Resistance: 1000MΩ min.  
 Contact Resistance: 20mΩ max.  
 Operating Temperature: -55°C ~+125°C.

### Features:

- \* Mates with Male 2Row Half  
 9001-37 Half Q Type.  
 9001-35 Half B Type.

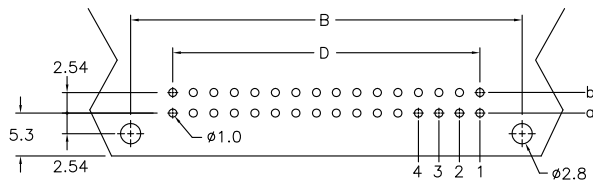
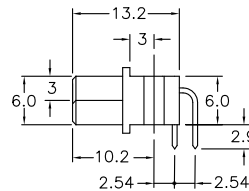
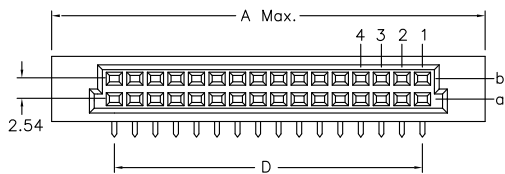
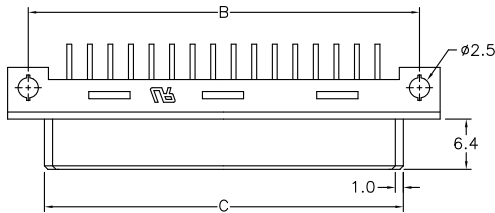

P.C. Board Layout

Dimension				
Position	A	B	C	D
32/16/8	54.00	48.26	44.40	38.10
20/10/5	38.80	33.02	29.20	22.86
Pitch	Position	Rows with Contacts	Contact Arrange	
2.54mm	32	a b		
	20	a b		
	16	a -		
5.08mm	10	a -		
	16	a b		
	10	a b		
	8	a -		
5	a -			

## Ordering information

**9001-** Series   
 **3**    3: 2.54mm  
                   4: 5.08mm   
 **8**    8: Female   
 **32**    Position   
 **1**    1: Dip Length   
 **C**    C: Selective Gold Plated   
 **00**    00: G/F   
 **L1**    L1: With Lock   
 **A**    A: Tray Package   
 See Page CA03

# 9001 Series

## DIN41612 Mating Introduce

---

2 Row insulator  
 B (Standard mounting)  
 Mounting axis  
 of the connector

3 Row insulator  
 C (Standard mounting)  
 Mounting axis  
 of the connector

Board lock available  
 L1=P.C.B. Thickness 1.6 ~2.0 mm  
 L2=P.C.B. Thickness 2.8 ~3.2 mm

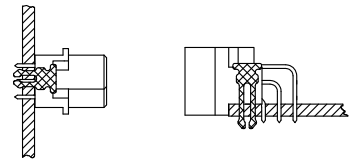
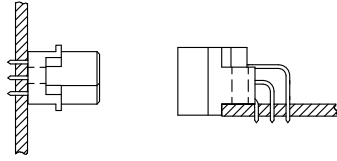
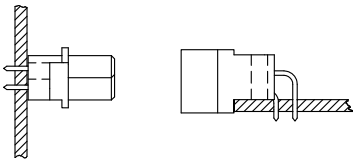

Q (Reverse mounting)  
 Mounting axis  
 of the connector

R (Reverse mounting)  
 Mounting axis  
 of the connector

Board lock available  
 L1=P.C.B. Thickness 1.6 ~2.0 mm  
 L2=P.C.B. Thickness 2.8 ~3.2 mm

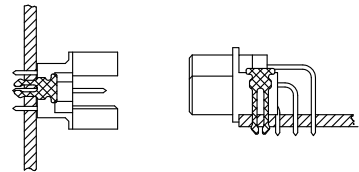
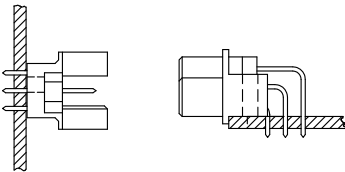
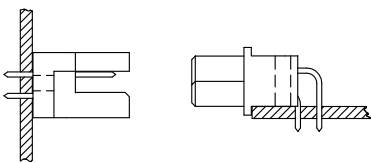

I.D.C. Type Ribbon Cable

Press Fit Type  
 2 Row insulator

3 Row insulator

2 Row insulator

3 Row insulator

